

AMENDED AND RESTATED DECLARATION
REGARDING CONSTRUCTION, OPERATION, AND
RECIPROCAL EASEMENTS

This Amended and Restated Declaration Regarding Construction, Operation, and Reciprocal Easements (the " Amended and Restated Declaration") is made this 27th day of September, 2023 ("Effective Date") by Ledge Rock Center, LLC., a Kansas limited liability company ("Declarant").

RECITALS

A. The Declarant executed and cause to be recorded the Declaration Regarding Construction, Operation and Reciprocal Easements, which was recorded against the Shopping Center Property on May 30, 2023 at Reception Number 4900791 in the Official Records of the Clerk and Recorder of Weld County, Colorado ("Original Declaration"). It is the intent of Declarant to amend the Original Declaration ,as it may under Section 17.1 of the Original Declaration, to correct and confirm certain reciprocal easements, covenants, and conditions with respect to the Parcels and Common Areas comprising the Shopping Center Property. Accordingly, The Amended and Restated Declaration shall supersede and replace the Original Declaration.

B. Declarant is the owner in fee simple and Developer of that certain real property located in the Town of Johnstown, County of Weld, State of Colorado, more particularly described in **Exhibit A-1** attached hereto, which real property consists of various parcels each referred to individually as "Parcels" and collectively as "Parcels" ("Parcel"). The term Parcels subject to this Amended and Restated Declaration, and any future subdivisions are hereinafter collectively referred to as the "Shopping Center Property" and collectively the Parcels and Metro District Property are known as Ledge Rock Center Shopping Center ("Shopping Center" Declarant). Ledge Rock Center Commercial Metropolitan District (the "District") is the owner in fee of that certain real property located in the Town of Johnstown, County of Weld, State of Colorado, more particularly described in **Exhibit A-3** attached hereto ("Metro District Property"). The District is not a party to the Amended and Restated Declaration and the Amended and Restated Declaration shall not be recorded against Metro District Property. The District's purpose is maintenance and operation of the Common Areas; for non-exclusive public parking, providing ingress, egress, and access to the public parking; and to coordinate with public utility companies to provide underground public utilities to the Shopping Center Property. To the extent that any easements or obligations are created in this Amended and Restated Declaration with regard to the Common Areas or Metro District Property, Declarant represents and warrants to the Owner(s) and Permittees that Declarant, after obtaining the Metro District's approval, will have the authority to grant, convey and impose and enforce such easements and obligations upon the Common Areas.

C. Declarant desires and intends that the Owner from time to time of the Parcels in the Shopping Center Property be committed to operate their respective Parcels as an integrated shopping center for the mutual benefit of such Parcels and, therefore, wishes to declare and establish certain reciprocal easements, covenants, and conditions with respect to the Parcels comprising the Shopping Center Property.

C. Declarant also desires (i) to make provision for regulation of construction of Stores (as defined in Article I below) on the various Parcels within the Shopping Center Property, as well as regulation of certain other improvements on and within the Shopping Center Property as are substantially consistent with the Site Plan attached hereto as **Exhibit B** and the terms of this Amended and Restated Declaration, and (ii) to construct certain Common Area improvements (as defined in Article I below) necessary for the integrated use of the Shopping Center on the Declarant Parcels.

D. In furtherance of the foregoing, Declarant, recognizing that, for the optimum development and operation of the Shopping Center as a unified and coordinated project, it is necessary that the Owners of the various Parcels within the Shopping Center Property be bound by certain restrictions, covenants and agreements respecting certain matters relating to construction, maintenance and operation of the Shopping Center (including, but not limited to, matters relating to the construction and maintenance of facilities on, and the operation, use and restrictions on the use of, the respective Parcels), and recognizing further that establishment of such restrictions, covenants and agreements will afford successor Owners of Parcels within the Shopping Center Property further assurances as an inducement to undertake development and/or operation on the various Parcels of the Shopping Center Property, Declarant does hereby declare that the Shopping Center Property is and shall be henceforth subject to the terms, provisions, easements, restrictions, covenants and agreements of this Amended and Restated Declaration hereinafter set forth, which easements, restrictions, covenants and other agreements are hereby established on the terms and conditions hereof such that the Shopping Center Property and each Owner of any Parcel or Parcels therein henceforth shall be subject to and bound by, the easements, covenants and restrictions hereinafter set forth, all so as to assure that all development on and within the Shopping Center Property will be in conformity herewith during the Term hereof.

NOW THEREFORE, in consideration of the above premises and the covenants herein contained, the Declarant does hereby declare that the Parcels and all present and future owners and occupants of the Parcels shall be and hereby are subject to the terms, covenants, easements, restrictions and conditions hereinafter set forth in this Amended and Restated Declaration, so that said Parcels shall be maintained, kept, sold and used in full compliance with and subject to this Amended and Restated Declaration and in connection therewith, Declarant covenants and agrees as follows:

ARTICLE I DEFINITIONS

1.1 **General Definitions.** Certain terms are defined in the text of this Amended and Restated Declaration and shall have the meanings ascribed to such terms where so defined elsewhere in the text. In addition to those defined terms, however, when used herein the following terms shall have the following meanings:

“Access Road(s)” shall mean those certain access ways and entrances shown and designated as such on-Exhibit B-1.

“Building Areas” shall mean the areas of the Shopping Center Property within which Stores (which for the purpose of this Amended and Restated Declaration shall include any appurtenant canopies, supports, loading docks, truck docks, turn-around loading delivery areas or the portions of truck ramps serving any

Store, and other outward extensions, as well as attached trash compactors and utility transformers) and any Outdoor Sales Area may be constructed, placed, or located; such areas being the within the Parcels.

“Common Area(s)” shall mean and refer, singularly or collectively, as applicable, to all land, improvements, which are part of the Shopping Center, owned by the Metro District and intended for nonexclusive use by the Owners and their Permittees, in common with other users as permitted by this Declaration. Common Areas shall include, but not be limited to, common utility lines and systems, parking areas, Access Roads, driveways, lanes, entrances, public restrooms, public halls and hallways, walkways, sidewalks, public elevators, escalators and stairs located within or about the parking areas and sidewalks (not to include any such facilities interior to a Store), landscaping, a Shopping Center management office, any detention or retention ponds, areas, and drainage facilities. The Common Areas shall include all areas surrounding the Stores outside the actual footprint of the Stores and still within the Shopping Center.

“Control Parcel” means the parcels of land more particularly described in **Exhibit A-4** attached hereto and depicted on **Exhibit B-4** Plat..

“Declarant” shall refer to Ledge Rock Center, LLC, a Kansas limited liability company, and Declarant’s successors.

“Defaulting Owner” is defined in Section 15.1 below.

“Design Criteria” shall mean Declarant’s design criteria handbook, which may be revised or amended from time to time by Declarant, which is available on the internet at <https://ledgerockcenter.com/wp-content/uploads/2022/05/Ledge-Rock-Center-PUD-Design-Guidelines-1-21-22.pdf>.

“Developer” is one and the same as Declarant as is Ledge Rock Center, LLC, a Kansas limited liability.

“Declarant Stores” shall mean the structures and improvements constructed and contained within the Parcels owned by Declarant.

“Stores” shall mean the structures and improvements constructed and contained within the Shopping Center Property.

“Environmental Laws” shall mean and include all federal, state and local environmental, wetlands, health and safety statutes, regulations, ordinances, codes, rules, decrees and other governmental restrictions and requirements relating to or regulating the waters of the United States, stream realignment or relocation, or water quality or relating to the existence, treatment, generation, storage, release, transportation, remediation management, regulation or disposal of pollutants, water pollutants or process waste water, oil and gasoline products, or otherwise relating in any way to the environment or any Hazardous Materials, including, but not limited to: (i) CERCLA; (ii) the Resource Conservation and Recovery Act of 1976 (42 USC Sec. 6901, et seq.); (iii) the Hazardous Materials Transportation Act (49 USC Sec. 1801, et seq.); (iv) the Clean Air Act (42 USC Sec. 7401, et. seq.); (v) the Safe Drinking Water Act (21 USC Secs. 201 and 300, et seq.), and the Clean Water Act (33 USC Sec. 1251, et seq.); (vi) the National Environmental Policy Act of 1969 (42 USC Sec. 4321); (vii) the Superfund Amendment and RE-Authorization Act of 1986 (42 USC Sec. 960, et seq.); (viii) all rules and regulations of the United States Environmental Protection Agency; and (ix) all rules and regulations of any other federal, state or local department, board, agency or entity having jurisdiction over any portion of the Shopping Center Property with regard to environmental, wetlands, health and safety matters, the waters of the United States, stream realignment or relocation, or water quality, as any of the foregoing have been, or are hereafter, amended.

“Floor Area” shall mean the gross number of square feet of floor space within a specified area (e.g., the Shopping Center Property, a building, specific leased premises, a Parcel), from time to time, of all floors in such structure, whether roofed or not, whether or not actually occupied, including basement space and

subterranean areas, measured from the exterior faces or the exterior lines of the exterior walls (including basement wall) and all permanent Outdoor Sales Areas. The term "Floor Area" shall not include any of the following: (a) The upper levels of any multi-deck stock areas created for convenience to increase the usability of space for stock purposes; (b) Areas, whether physically separated or whether otherwise required by building codes, which are used exclusively to house mechanical, electrical, telephone, telecommunications, and HVAC equipment, and other such building operating equipment; (c) All interior or exterior truck loading areas, truck tunnels, and truck parking, turn around and dock areas and ramps; (d) All Common Area; and (e) Mezzanines and any interior second story not open to customers and incidental to ground floor retail operations.

"Hazardous Material" shall mean (i) any substance now or hereafter defined as a "hazardous substance" under the Comprehensive Environmental Response, Compensation and Liability Act of 1980 (42 USC §9601, et seq.) ("CERCLA"), (ii) petroleum, petroleum products, natural gas, natural gas liquids, liquefied natural gas, and synthetic gas, natural gas, and (iii) any other substance, material or product addressed under any Environmental Law or otherwise deemed to be hazardous, harmful, dangerous, toxic, or a pollutant.

"Mortgagee" shall mean a mortgagee, or trustee and beneficiary under a Mortgage (as hereinafter defined), and to the extent applicable, a fee owner or lessor or sublessor of any Parcel which is the subject of a lease under which any Owner becomes a lessee in a so called "Sale and Leaseback" or "Assignment and Sub leaseback" transaction. The term **"Mortgage"** means any first mortgage, indenture of first mortgage, or first deed of trust of the interest, whether fee or leasehold, of an Owner in a Parcel and, to the extent applicable, a "Sale and Leaseback" or "Assignment and Sub leaseback" transaction as herein contemplated.

"Non-Defaulting Owner" is defined in Section 15.1 below.

"Normal Business Hours" shall mean from 8A.M. to 9P.M. Mountain Standard Time.

"Official Records" shall mean the land records of Weld County, Colorado.

"Operator" is defined in Section 8.1 below.

"Outdoor Sales" shall mean any use by a Permittee for temporary or permanent sales, displays, and/or customer seating or other activities, which areas are located outside of the structure of such Permittee's Store. Outdoor Sales are subject to Declarant's approval.

"Owner" and **"Owners"** as used in this n shall initially mean Declarant with respect to the Shopping Center Property until Declarant, subject to Article VII, has transferred fee title in and to a Parcel(s) to another Person; and thereafter as to the Parcel so transferred, shall mean the successor or successors to such Declarant as so determined in accordance with the provisions of Article VII

"Parking Area" shall mean those portions of the Common Area within the Shopping Center used for the parking of motor vehicles, including incidental and interior roadways, pedestrian stairways, walkways, curbs, and landscaping within or adjacent to areas used for parking of motor vehicles, together with all improvements to the Common Area which at any time are erected thereon.

"Permittee" shall mean the Owners, all Persons from time to time entitled to the use and occupancy of any Floor Area in the Shopping Center under any lease, deed or other arrangement where under such Person has acquired a right to the use and occupancy of any Floor Area in the Shopping Center, and their respective officers, directors, employees, agents, contractors, customers, visitors, invitees, licensees and concessionaires.

"Person" or **"Persons"** shall mean and include any individual, partnership, firm, association, joint venture, corporation, or any other form of business entity.

"Project Architect" shall mean such architect or architects duly licensed to practice in the State of Colorado, as may from time to time be designated by Declarant.

“**Real Property Taxes**” is defined in Section 13.1 below.

“**Related Corporation**” shall mean a corporation, partnership, or other business entity, which directly or indirectly, controls, is controlled by, or is under common control with, another corporation, partnership, or business entity. If more than fifty percent (50%) of the voting stock of a corporation shall be owned by another corporation, partnership, or other business entity, the corporation whose stock is so owned shall be deemed to be controlled by the corporation, partnership, or other business entity owning such stock.

“**Rules and Regulations**” are defined in Article XVIII below.

“**Separate Agreement(s)**” shall mean any legally binding agreement related to the Parcel or the Shopping Center Property.

“**Site Plan**” shall mean the Site Plan attached hereto as **Exhibit B** and incorporated herein by this reference.

“**Term**” is defined in Article X below.

“**Transfer**” means a conveyance by way of sale, assignment, lease, grant or transfer, including, without limitation, the same portion of a “Sale and Leaseback” (as defined in Section 12.2) and/or “Assignment and Sub leaseback” (as defined in Section 12.2), but excluding the making of a Mortgage.

“**Transferee**” means the purchaser, assignee, grantee, lessee, or transferee in a particular Transfer.

“**Transferor**” means the seller, assignor, grantor, lessor, or transferor in a particular Transfer.

ARTICLE II EASEMENTS

Declarant hereby declares, establishes, creates, grants, and conveys, for the benefit of each of the Parcels and the Owners thereof from time to time, the following easements in, to, over, and across the Common Area of the Shopping Center Property:

2.1 Access Easements.

(a) **Each** of the Parcels and the Owners thereof shall have nonexclusive easements in, to, over and across the Common Areas, including driveways (provided, however, that such Common Areas, including driveways, are integral part of the Shopping Center), for vehicular (including service vehicles) and pedestrian ingress and egress, and access and the right of access over established circulation roads, and ways between the public streets adjacent to the Shopping Center and any Parcel situated in the Shopping Center.

(b) Each of the Parcels and the Owners thereof shall have nonexclusive easements in, to, over and across any portion of the Access Roads located on a given Parcel (provided, however, that such Access Roads are within the Shopping Center) for the purpose of ingress and egress to, from and between an Owner's Parcel and any public road or highway adjacent to the Shopping Center.

(c) Declarant and/or its successors and assigns shall have a non-exclusive easement in, to, over and across each Parcel and the Common Area (provided, however, that such Parcels and Common Areas are within the Shopping Center Property) for the purpose of accessing, repairing, replacing, or maintaining the Common Area.

2.2 **Utility Easements.** Each of the Parcels and the Owners thereof shall have nonexclusive easements in, to, over, across and under the Common Area for the benefit of and appurtenant to each for the purposes of installation, repair, replacement and maintenance of sewers, water and gas pipes and systems, electrical power conduits, telephone conduits, lines and wires, and other public utilities beneath the ground surface at the exact location of the subject to the approval of the Owners of the Burdened Parcel in writing. Provided that in all cases, in the performance of such installation, repair, replacement and/or maintenance: (a) adequate provision shall be made for the safety and convenience of all persons using the surface of such

areas; (b) the areas and facilities (including without limitation paving and landscaping) shall be replaced or restored to the condition in which they were prior to the performance of such work by the Owner performing such work; (c) the other Owners shall be held harmless and indemnified by the Owner performing or causing to be performed such work against claims, damages and losses, including court costs and reasonable attorneys' fees arising from the performance of such work or use of such easements; (d) except in the event of an emergency, Declarant and any Owner that is affected by such work shall be notified in writing not less than thirty (30) days prior to commencement of such work; (e) such work shall not conflict with other utility lines, conduits and facilities, and shall have been previously reasonably approved by all owners of such lines, conduits and facilities which are situated within 20 feet of any point of such proposed line, conduit or facility; (f) such work shall not unreasonably interfere with the normal and usual operation of the servient Owner's respective Parcel, customer parking or the Shopping Center; and (g) such work shall be scheduled in a manner intended to minimize, to the extent reasonably practicable, performance of any such work between November 1 to January 4 or during the thirty (30) day period prior to Easter, it being understood that the foregoing limitations in no way restricts performance of such work in the event of an emergency, if required by applicable governmental authorities and/or with respect to any initial construction or restoration following a casualty upon a Parcel in accordance with the terms of this Amended and Restated Declaration. Franchises granted to public utilities for such utilities shall constitute compliance with the foregoing provisions. In addition, each Owner shall be obligated to perform such other acts, and to execute, acknowledge and/or deliver such instruments, documents and other materials as Declarant or an Owner may request in order to document any such easement in a commercially reasonable manner. Any servient Owner shall have the right, upon not less than sixty (60) days of notice to the benefited Owner or Owners, at any time and from time to time, to move and relocate any such facility within such servient Owner's Parcel; provided, however, that (i) such relocation shall be made at the relocating-servient Owner's sole cost and expense, (ii) neither the relocation nor the relocated facility shall interfere with, nor increase the cost of, utility service to any benefited Owner, nor unreasonably interfere with the operation of any business being conducted on the Parcel of any benefited Owner, and (iii) such work shall otherwise comply with the terms of this Section.

2.3 Easements to Public Utilities. Nothing herein contained shall restrict or prevent an Owner from granting to any public utility, public body or other public authority easements over or under the Common Area located on its Parcel, for public utility lines and facilities, water, storm and sanitary sewer lines and conduits and facilities therefor, or for drainage or slope purposes, or for other pipe line purposes; provided that such easements do not adversely affect any parking area or other use of any Common Area in the Shopping Center. Any grant or other conveyance of an easement to a public utility by an Owner (who under such grant becomes the grantor) on its own Parcel(s) after the recording of this Amended and Restated Declaration shall, without necessity of further recital in the conveyance instrument, be deemed to include the following conditions, covenants and restrictions to which such public utility and its successors shall be bound unless specifically stated otherwise in such instrument:

- (a) The easement is non-exclusive;
- (b) All facilities installed pursuant to the easement shall be underground, except for ground mounted transformers, fire hydrants, manholes and manhole covers which shall be flush with adjacent grade, and except as otherwise shown on plans approved by grantor.
- (c) The grantor retains the right to use the surface areas as grantor sees fit, provided and so long as such uses are not inconsistent with the easement rights herein established;

- (d) The grantor reserves the right to require the grantee to relocate its facilities (and vacate the easement) to another location on the grantor's Parcel, subject to the conveyance of a similar easement, all at the grantor's cost and expense; provided that such relocation shall not be commenced (except in case of emergency) during the months of November, December or January without the prior consent of each Owner on whose Parcel such relocation will take place;
- (e) The grantee shall not, in its use or installation, interfere with other installations and easements in the area; and shall protect its facilities against uses of the surface made by the grantor and others;
- (f) The grantee shall make adequate provisions for the safety and convenience of all persons using the area and following installation or other work, shall replace and restore the areas and improvements (including without limitation paving and landscaping) to the condition in which they were immediately prior to performance of such installation and work;
- (g) The grantee shall defend, indemnify, and hold harmless grantor against all loss, liability, and costs (including reasonable attorney's fees) which may result to grantor from the negligent act or omission of grantee, its agents, employees and contractors;
- (h) The grantee shall not permit any claim, lien, or encumbrance to attach against the grantor's Parcel or any other Parcel or any interest therein; and
- (i) No easement shall be granted to a public utility which unreasonably interferes with the construction, use, and enjoyment of any Parcel or the rights granted to the Owners hereunder.

2.4 **Drainage.** Each of the Parcels and the Owners thereof shall have nonexclusive easements in, to, over, and through the drainage patterns and systems as are established from time to time within the Common Area, for reasonable surface drainage purposes. To the extent an Owner's Parcel includes Common Area, nothing herein shall prevent such Owner from relocating the drainage patterns established upon such Owner's Parcel provided such Owner first provides Declarant with plans respecting such relocation and such relocation does not unreasonably interfere with the drainage of other Parcels within the Shopping Center nor interfere with the orderly discharge of water by means of same. Each of the Parcels or Owner thereof shall take no action to affect the utility of the two drainage ponds within the Shopping Center Property.

2.5 **Encroachment.** Each of the Parcels and Owners thereof shall have nonexclusive easements in, on, over and under the Common Area in or on Shopping Center Property for minor encroachments (together with the maintenance thereof) such as building overhangs, building support columns, canopies, eaves, foundations, slabs, footings, pillars, and other minor encroachments. Neither such easements nor minor encroachments shall unreasonably (i) interfere with Declarant's use or operation of the Shopping Center, (ii) interfere with the adjacent Owner's use or operation of its Parcel, (iii) restrict or limit the operation or use of any Building or other improvement constructed on the adjacent Owner's Parcel, and/or (iv) limit or restrict the type of Building or other improvements that may be constructed on the adjacent Parcel and such encroachments shall be independent of the adjacent Owner's Parcel and shall not receive any structural support from any improvement located on such adjacent Parcel. Notwithstanding the foregoing, this subparagraph shall not create easements for intentional encroachments.

2.6 **Execution of Documents.** Each of the Owners shall be bound to execute such documents in recordable form as may be applicable and necessary to effectuate the provisions of this Article II, and any provisions of this Amended and Restated Declaration, including, but without limitation, any documents

granting easements, licenses and similar rights to utility companies and governmental bodies or agencies thereof.

2.7 Unimpeded Access Between Parcels. Subject to Declarant's rights and obligations with respect to the maintenance of Common Area, it is declared and established that the Owners at all times during the Term of this Amended and Restated Declaration shall have free access over Common Area between each Parcel and the remainder of the Shopping Center Property, that such access will not be impeded and that such access will be maintained in a manner consistent with the Site Plan for the Shopping Center, as same may be modified in accordance with the provisions of this Amended and Restated Declaration.

2.8 Use by Permittees. Subject to the Rules and Regulations, the use of all easements provided for in this Article, and the use of the entire Common Area in or on Shopping Center Property will, in each instance, be nonexclusive, and for the use and benefit of all Permittees, except as otherwise expressly stated herein.

2.9 Unauthorized Use and Closure of Common Area. Declarant hereby reserves the right to eject (or cause ejection from the Common Area of) any Person or Persons not authorized, empowered, or privileged to use the Common Area in or on Shopping Center Property pursuant to this Amended and Restated Declaration. Each Owner shall have and is hereby reserved the right to close off the Common Area located exclusively on its Parcel for such reasonable period or periods of time as may be legally necessary to prevent the acquisition of prescriptive rights by anyone; provided, however, that prior to taking such action, the Owner intending to do so shall notify the other Owners of such intention and shall attempt to coordinate its closing with such other Owner's activities so that no unreasonable interference with the operation of the Shopping Center shall occur. Furthermore, no such closing shall occur within the period of time between November 1 of any calendar year through January 4 of the next succeeding calendar year nor during the thirty-day period prior to Easter, except that any such closing may occur on Christmas Day (provided and so long as customary practice in the retail shopping center industry is for stores to be closed on Christmas Day).

2.10 Prohibition Against Granting Easements. Except as otherwise permitted herein, other than Declarant, no Owner, or any Person not an Owner, shall grant any easement for the benefit of any property not within the Shopping Center and/or the Common Area.

2.11 Term of Easements. The easements set forth in Article II shall be effective commencing on the date of recordation of this Amended and Restated Declaration in the office of the Weld County Recorder and shall remain in full force and effect thereafter in perpetuity, unless this Amended and Restated Declaration is modified, amended, cancelled, or terminated by written consent of all the record Owners of the Parcels. By taking title subject to this Amended and Restated Declaration, each subsequent Owner shall be deemed to have ratified and to have joined in the grant of the easements set forth herein without the necessity of execution or delivery of any further instrument.

2.12 Parking Easements. Each of the Parcels and the Owners thereof shall have non-exclusive easements in, to, over, and across the Common Area for the purpose of parking vehicles of Permittees in the Parking Areas thereon. Declarant acknowledges that although certain Parking Areas are located within the Metro District's Parcel, Declarant represents and warrants that Owners as designated by Declarant shall

have access in, to, over, and across the Metro District's Parcel for the purpose of parking vehicles of Permittees in the Parking Areas thereon.

ARTICLE III CONSTRUCTION REQUIREMENTS

3.1 **Construction Compatibility.** No improvements shall be constructed, erected, expanded, or altered on the Parcels until the plans and specifications for same (including, but not limited to, site layout, exterior building materials and colors, and landscaping) have been approved in writing by Declarant. Each Owner shall, during the period prior to commencement of construction, consult with the Project Architect and Declarant concerning the exterior design, color treatment and exterior materials to be used in the construction, of all buildings and structures, including sidewalks, on its respective Parcel(s). Each Owner shall cause its respective architect to work in good faith with the Project Architect and Declarant so that the buildings to be erected and constructed will have an overall cohesive and related architectural continuity and will be in harmony with the balance of the Shopping Center improvements. Any improvements constructed, erected, expanded, or altered on the Parcels shall be in accordance with the Ledge Rock Design Guidelines.

3.2 **Performance of Construction.** Each Owner shall be bound to perform all construction on its respective Parcel or Parcels, (i) in accordance with the applicable plans and specifications as approved in this Amended and Restated Declaration and, as applicable, each Owner's Separate Agreement; (ii) with due diligence and in a good and workmanlike manner, using new and/or first-class materials; (iii) in full cooperation with the other Owners to the extent necessary to effect a unified, integrated shopping center development; (iv) in accordance with all applicable laws, ordinances, rules and regulations of all governmental and quasi- governmental agencies and authorities having jurisdiction over such construction, including, but not limited to, the Americans with Disabilities Act of 1990 and all orders, rules and regulations of the National Board of Fire Underwriters or any other body now or hereafter constituted performing similar functions in the County of Larimer, State of Colorado; (v) only after having procured and paid for, so far as the same are required, all municipal and other governmental permits and authorizations of the various departments and governmental subdivisions having jurisdiction; and (vi) in accordance with the terms and provisions of this Amended and Restated Declaration. The Owners in the performance of their construction shall not (x) cause any unnecessary or unreasonable increase in the cost of construction of any other Owner; (y) unreasonably interfere with any other construction being performed on the Shopping Center Property; or (z) unreasonably impair the use, occupancy or enjoyment of the Shopping Center Property or any part thereof as permitted or contemplated by this Amended and Restated Declaration.

3.3 **Construction Indemnities.** Each Owner shall indemnify, defend, and hold harmless the other Owners from and against all claims and all costs, expenses and liabilities (including reasonable attorneys' fees) incurred in connection with all claims, including any action or proceedings brought thereon, arising from or as a result of any mechanic's liens, or other claims regarding materials supplied or work performed, or the death of, or any accident, injury, loss or damage whatsoever caused to, any natural Person, or to the property of any Person, as shall occur by reason of the performance of any construction by or at the request of the indemnitor, except for claims caused by the negligence or willful act or omission of the indemnitee, its licensees, concessionaires, agents, servants or employees, or any agents, servants or employees of such licensees or concessionaires where the same may occur. If any mechanic's, materialman's, or other similar lien shall at any time be filed against any part of the Shopping Center

Property on account of any work, labor or services performed or claimed to have been performed, or on account of any materials furnished or claimed to have been furnished, for or at the direction of an Owner or anyone holding or occupying such Owner's Parcel or Store through or under such Owner, such Owner shall, without cost or expense to any other Owner, forthwith cause the same to be either (i) discharged of record by payment, bond, order of a court of competent jurisdiction, or otherwise or (ii) contest it (so long as such contest can be conducted without risk of forfeiture as to any of the easement rights and other privileges and benefits created by this Amended and Restated Declaration), in which event any judgment or other process issued in such contest shall be paid or discharged within One Hundred and Twenty (120) Days of recordation of such lien..

3.4 **Indemnitee to Provide Notice.** The indemnitee shall give the indemnitor notice of any suit or proceeding entitling the indemnitee to indemnification pursuant to this Section and the indemnitor shall defend, at the indemnitor's cost, the indemnitee in such suit or proceeding with counsel approved by the indemnitee.

3.5 **Cost of Construction.** Except as otherwise set forth in this Amended and Restated Declaration or a separate agreement with Declarant, each Owner shall be responsible for the cost and expense of all improvements to be constructed on its Parcel.

3.6 **Safety Measures.** Each Owner shall at all times take any and all safety measures reasonably required to protect the other Owners from injury or damage caused by or resulting from the performance of its construction.

3.7 **Architects Certificates.** During the Term of this Amended and Restated Declaration, all architects employed in connection with any construction on the Owners' respective Parcels shall be certified architects licensed to practice in the State of Colorado or will affiliate with an architect so licensed. Upon request of an Owner, the Owner to whom such request is made shall cause the architect who prepared plans and specifications for any construction on an owner's Parcel to deliver a certificate to the Owner making the request, stating the actual Floor Area constructed. Each Owner shall cause its architect, upon request, to give notice to the other Owners by a certificate stating the actual Floor Area and any net change of Floor Area on such Owner's Parcel.

ARTICLE IV **SHOPPING CENTER DEVELOPMENT RESTRICTIONS**

4.1 **Common Area.** Except as shown on the Site Plan and as provided below, no improvements may be built or maintained in the Common Area in or on Shopping Center Property other than parking lots, curbs, driveways, lights, sidewalks, signs, kiosks, merchandise carts, landscaping, trash receptacles or enclosures and other improvements normally found in a parking lot or common area without Declarant's written consent, which consent may be arbitrarily withheld by Declarant in its sole discretion.

4.2 **Certain Closures, Alterations, Etc.** Except as otherwise prohibited herein, Declarant reserves the right from time to time without notice to any Owner (except as further provided below), to close temporarily

any of the Common Area in connection with the performance by Declarant of its repair and maintenance obligations, provided that any such work shall, to the extent reasonably practicable, be scheduled in a manner intended to minimize interference with the ordinary conduct of business within the Shopping Center Property. In particular, but without limitation, any such closure shall be scheduled in a manner intended to minimize, to the extent reasonably practicable, performance of any such work between November 1 to January 4 or during the thirty day period prior to Easter, it being understood that the foregoing limitation in no way restricts closure in the event of an emergency, if required by applicable governmental authorities and/or with respect to any initial construction or restoration following a casualty upon a Parcel in accordance with the terms of this Amended and Restated Declaration. Declarant further reserves the right from time to time without notice to any Owner (i) to make changes to the Common Area, including, without limitation, driveways, ramps, entrances, exits, passages, stairways and other ingress and egress, landscaped areas, loading and unloading areas, and walkways; (ii) to add additional Stores, to expand existing stores, or to enlarge and change, redevelop, redesign any improvements or enlarge and/or change any Building Area or Floor Area; (iii) to use the Common Area while engaged in making additional improvements, repairs or alterations to the Shopping Center or to any adjacent land, or any portion thereof; and (iv) to do and perform such other acts and make such other changes in, to or with respect to the Shopping Center and Common Area or the expansion thereof as Declarant may, in the exercise of sound business judgment, reasonably deem to be appropriate.

4.3 Roof Top Equipment; Trash Enclosures. Roof top mechanical and telecommunications equipment (including, without limitation, any antennae or satellite dishes) shall be screened from public view from adjacent public streets and highways and in a manner satisfactory to Declarant. Any trash facility shall be screened from public view from adjacent public streets and highways on all four sides or in a manner otherwise satisfactory to Declarant.

4.4 Obstructions. Except as specifically depicted on the Site Plan or as may be approved in writing by the Declarant in its sole discretion, no fence, division, partition, rail, or obstruction of any type or kind (excluding landscaping) shall ever be placed, kept, permitted, or maintained between the Parcels or between any subsequent division thereof or upon or along any of the common property lines of any portion thereof and except as may be required at any time and from time to time in connection with the construction, maintenance, and repair of Common Area.

4.5 Signs. Exterior signs of any type, and their construction and installation, are subject to Declarant's approval, which shall not be unreasonably withheld, delayed, or conditioned, and must comply with the Ledge Rock Center Sign Criteria and Ledge Rock Center Design Handbook.

4.6 Lighting. The Owner of each Parcel shall implement a lighting plan relative to the Common Area located on such Parcel and install lighting pursuant to said plan in accordance with the guidelines contained in the Ledge Rock Center Design Handbook. The accent lighting, exterior building lighting and interior building lighting on each Parcel are subject to this Amended and Restated Declaration, the Ledge Rock Center Design Handbook any and all applicable government rules, laws, ordinances, regulations and statutes, and any requirements of this Amended and Restated Declaration. After completion of the lighting system on an applicable Parcel and during the remaining Term of this Amended and Restated Declaration, each Parcel shall be fully illuminated each day from dusk until at least the end of Normal Business Hours. During the

Term of this Amended and Restated Declaration (and thereafter so long as the Store utilizing the following described license exists, subject to a reasonable period to permit reconstruction or replacement of such Store if the same shall be destroyed, damaged, or demolished), the Owner of each Parcel and is hereby granted an irrevocable license for the purpose of permitting the lighting from one Parcel to incidentally shine on the adjoining Parcel.

4.7 Parking Ratio and Standards. During the entire Term of this Amended and Restated Declaration, the Parking Area shall be maintained in accordance with the Site Plan and the requirements of the governmental authorities applicable to the Shopping Center Property (including the Metro District Parcel) so that the overall Parking Area of the Shopping Center contains the number of parking spaces to satisfy a ratio of four and one-half (4.0) parking spaces for each one thousand (1,000) square feet of Floor Area located within the Shopping Center (including the Metro District Parcel).

4.8 Parking Charges. No metered or other direct parking charge shall be made by any Owner or the District on any of its land included in the Shopping Center Property or the Metro District Parcel or by their successors or assigns, it being the intention of the Declarant that the right to park in the Common Area shall be free of any direct charge whatsoever except as may be required by law and except that Declarant may charge a fee if it provides valet parking services.

ARTICLE V

USE RESTRICTIONS AND COVENANTS

5.1 Use In General. Subject to the limitations set forth below, the Shopping Center Property shall be used during the Term hereof for retail and other businesses common to first class shopping centers and mixed- use developments located in the State of Colorado. None of the following uses or operations will be made, conducted, or permitted on or with respect to all or any part of the Shopping Center Property (the "Restricted Property") at any time:

- (a) any gas or service station or automobile service facility;
- (b) any residential use, elderly care facility, or nursing home;
- (c) any noise or sound that is reasonably objectionable due to intermittence, beat, frequency, shrillness, or loudness;
- (d) any obnoxious odor;
- (e) any excessive quantity of dust, dirt, or fly ash; provided however, this prohibition shall not preclude the sale of soils, fertilizers, or other garden materials or building materials in containers if incident to the operation of a home improvement or other similar store;
- (f) any fire, explosion or other damaging or dangerous hazard, including the storage, display or sale of explosives or fireworks;
- (g) any assembly, manufacture, distillation, refining, smelting, agriculture, or mining operations;
- (h) any mobile home or trailer court, labor camp, junkyard, mortuary, stock yard or animal raising. Notwithstanding the foregoing, (1) pet shops shall be permitted within the Shopping Center Property; and (2) the foregoing shall not prohibit the temporary installation of construction trailers during periods of construction, reconstruction, or maintenance;

- (i) any drilling for and/or removal of subsurface substances;
- (j) any dumping of garbage or refuse, other than in enclosed receptacles intended for such purpose;
- (k) any automobile, truck, trailer or recreational vehicle sales, rental, leasing or body and fender repair operation, however such restrictions shall not preclude a car wash or auto part store;
- (l) any flea market and/or swap meet;
- (m) any massage parlor, adult book shop, movie house or other establishment selling or exhibiting pornographic materials or other pornographic use; provided, however, that such restrictions shall not preclude the (i) showing of films in any first rate motion picture theater operated in the Shopping Center, so long as such motion picture theater does not show any picture that has received an "NC-17" from the Motion Picture Association of America or any successor to the Motion Picture Association of America which rates motion pictures or any other pictures that are considered pornographic by the Town of Johnstown, (ii) sale or rental of adult books, magazines or videos (including, without limitation, video cassettes, DVDs, laserdiscs and other like media) as an incidental part of the business of a general purpose bookstore or retailer carrying a general selection of books, magazines and video products (such as, by way of example and without limitation, Target, Best Buy and Blockbuster Video) normally found in a first class shopping center or (iii) massages in connection with a beauty salon, spa operation or massage therapy operation which are normally found in a first class shopping center;
- (n) any abortion clinic or drug rehabilitation clinic;
- (o) any warehouse or industrial use;
- (p) any self-storage facility;
- (q) any tattoo or body piercing parlor;
- (r) any public or private nuisance;
- (s) any cemetery, mortuary, or similar service establishment;
- (t) any fire sale or bankruptcy sale, unless pursuant to a court order, or auction house operation;
- (u) any pawn shop;
- (v) any establishment selling drug paraphernalia or dispensary;
- (w) any roller skating rink, bowling alley, teenage discotheque, dance hall, video game parlor, pool room card club, bingo parlor, facility containing game equipment (other than for the retail sale thereof), or carnival activities; provided the foregoing shall not preclude (i) the seasonal outdoor ice rink; (ii) any restaurant properly operating within the Shopping Center from having a dance floor for the enjoyment of their patrons therein, so long as incidental to the operation of the restaurant; (iii) use and operation of video games within restaurants otherwise permitted in the Shopping Center, so long as incidental to the operation thereof; and (iii) use and operation of entertainment/restaurant complex, which serves food and beverages and provides an array of interactive entertainment attractions such as billiards, shuffleboard, simulators, virtual reality and games of skill (such by example and without limitation (Dave & Buster, ESPN Zone, 810 Zone or BRK Through);
- (x) any dry-cleaning facilities utilizing hazardous substances or hazardous Materials with an on-premises plant;
- (y) any unemployment agency, service, or commission; and
- (z) any gambling facility, including but not limited to, off-track or sports betting parlor.

5.2 **Non-Interference with Common Area; Outdoor Sales.** In order to provide for the orderly development and operation of the Shopping Center:

(a) No Owner shall cause, maintain, or permit any nuisance in, on or about the Shopping Center. Declarant shall be permitted to grant the right to allow any Permittee to conduct Outdoor Sales within a specified area, including the right to allow Permittees of the Shopping Center to conduct, from time to time (and not on a permanent basis), sales in the sidewalk areas immediately adjacent to such Permittee's Store

(b) No Owner shall permit any Permittee of said owner's Parcel to carry any merchandise or substance or to perform any activity in relation to the use of such owner's Parcel which would (i) cause or threaten the cancellation of any insurance covering any portion of the Shopping Center or (ii) increase the insurance rates applicable to the Common Area or the Stores on the other Owner's Parcel over the rates which would otherwise apply unless such Permittee shall pay the increased insurance cost on demand.

ARTICLE VI COMPLIANCE WITH LAWS

6.1 **Compliance with Laws.** Each Owner shall not use (and shall use its commercially reasonable efforts to prohibit its respective Permittees from so using; provided, however, such Owner shall not be responsible for any violations by its Permittees) its respective Parcel(s), or any part thereof, or any building or other improvement thereon, in violation of the laws of the United States of America, the State of Colorado, or the ordinances, regulations or requirements of the local municipal or county governing body or other lawful authorities having jurisdiction over the Shopping Center and all covenants, conditions, and restrictions relating to the Shopping Center including, but not limited to, this Amended and Restated Declaration, and any amendments or modifications thereto. Notwithstanding the foregoing, any Owner may refrain from complying with or causing compliance with any such law, ordinance, regulation or requirement of the United States of America, the State of Colorado and/or the local municipal or county governing body or other local authorities having jurisdiction over the Shopping Center so long as the validity thereof shall be contested in good faith by appropriate proceedings; provided that (a) such Owner shall defend and hold harmless the other Owners from penalties or other expenditures arising from or as a result of such non-compliance, (b) the other Owners would not be in danger of incurring any civil or any criminal penalty or liability by reason of such contest, and (c) no part of the Shopping Center would be in danger of being sold, forfeited or lost by reason of such proceedings or would be subject to the imposition of any lien as a result of a failure to comply with any such law, ordinance, regulation or requirement.

ARTICLE VII MAINTENANCE OF IMPROVEMENTS

7.1 **Maintenance of Improvements.** Except as otherwise provided herein (including without limitation Declarant's maintenance of the Common Area as set forth in Article VIII), each Owner shall, for

the benefit of the Owners at all times during the Term of this Amended and Restated Declaration, maintain, or cause to be maintained, the exterior of Stores and other improvements, including (without limitation) Common Area, from time to time located on such Owner's Parcel (including but not limited to, any sidewalks, curbs, landscaping and other improvements which are located between the exterior building face of such Owners Store and the exterior curb face of the perimeter sidewalk located around such Owner's Store), in a first class condition and in good order, maintenance, and repair consistent with similar first class shopping centers located in Weld County, Colorado, and in accordance with this Amended and Restated Declaration.

ARTICLE VIII
OPERATION AND MAINTENANCE OF COMMON AREA

8.1 Maintenance of Common Area. During the Term hereof, Declarant will do or cause to be done, with respect to the Common Area and common area within Metro District Property, with respect to Metro District Property that it has contracted with the District to build, maintain, or repair, will do or cause to be done, the following: (i) maintain, repair and/or replace, or cause to be maintained, repaired and/or replaced, the Common Area so as to keep it in first class condition consistent with other first class shopping centers in Weld County, Colorado, (ii) clean the Common Area and keep same free of rubbish and other hazards to persons using such area, (iii) properly light the portions of the Common Area not the responsibility of the Owners of the various Parcels in accordance with the further terms of this Amended and Restated Declaration and (iv) maintain the landscaping within the Common Area. Such obligations shall include, without limitation, providing adequate security protection services (if similarly situated shopping centers located in the Weld County, Colorado trade market area are provided security protection services or if Declarant otherwise determines same to be reasonably necessary or appropriate), maintaining, repairing and replacing all above and underground utilities, common utilities and other utility conduits and lines and sewers located within the Shopping Center Property (except within those utility easements granted to any governmental authority or utility company, which has maintenance and repair obligations thereover, and except for service drops exclusively serving improvements on a particular Parcel, rather than the Shopping Center as a whole, which service drops shall be the maintenance responsibility of the Owner utilizing same), maintain, repairing, repainting and replacing all directional/way-finding signs, maintaining, repairing and replacing all lighting facilities (including bulbs and ballasts), maintaining, repairing and replacing all irrigation systems, maintaining and replacing as necessary the plants located within the landscaped and planted areas, resurfacing and restriping all Parking Areas in the Common Areas, and repairing all holes or breaks in the paving in the Common Area within a reasonable time after the same appear, causing all garbage receptacles of all occupants of Buildings as well as those located in the Common Area to be emptied as needed, collection and disposal of all paper and trash in all Common Area each day as needed and sweep all sidewalks, all drives adjacent to all Stores and other Buildings located in the Shopping Center as needed, and remove, and treat, ice and remove snow from the exposed areas as soon as practicable. Declarant shall, to the extent reasonably practicable, endeavor in good faith to schedule any extraordinary work to be performed in accordance with the foregoing provisions in a manner intended to minimize interference with the ordinary conduct of business within the Shopping Center. In particular, but without limitation, any such extraordinary work reasonably expected to cause a temporary closing of any of the Common Area shall be scheduled in a manner intended to minimize, to the extent reasonably practicable, performance of any such work between November 1 to January 4 or during the thirty day period prior to

Easter, it being understood that the foregoing limitation in no way restricts closure in the event of an emergency or if required by applicable governmental authorities. Declarant will have the right to select from time to time a person or persons other than Declarant to operate and maintain the Common Area or portions thereof ("Operator"), provided that such selection will not diminish Declarant's obligations to maintain and operate the Common Area. The Owners of all Parcels within the Shopping Center will be required to pay their pro rata share of Declarant's expenses in connection with maintenance of such Common Area in accordance with this Amended and Restated Declaration.

8.2 Succession to Maintenance Obligations. It is understood and agreed that the obligations of the Declarant hereunder to maintain the Common Area and administer the provisions of this Amended and Restated Declaration respecting common area obligations shall attach to and run with title to the Control Parcel such that the Owner or Owners from time to time of the Control Parcel shall be responsible for the performance of the obligations of the Declarant arising under the Amended and Restated Declaration and pertaining to the Shopping Center. From and after conveyance of the Control Parcel by Declarant to another Person, any other Person succeeding to the Declarant's interest as Owner of any of the Declarant's Parcels other than the Control Parcel shall have no liability or obligation for performance of the obligations of the Declarant arising under the Amended and Restated Declaration and pertaining to the Shopping Center; provided that the foregoing shall in no way absolve any such Owner of the obligation to perform the obligations of an Owner pertaining specifically to the Parcel of Parcels of such Owner.

8.3 Understanding CAM Charges. Because the Common Areas are owned by the Metro District, the provider of services to the Metro District must procure a Single Price Contract ("SPC") for ground maintenance of the Common Areas.. The process of contracting for ground maintenance requires a SPC for all services approved by the Metro District, which services and operations are governed by a master agreement with the Metro District setting forth minimum standards for ground maintenance of the Common Areas. Therefore, Owners recognize that if Declarant or one of Declarant's affiliates provides the ground maintenance of the Common Areas, that Declarant and/or Declarant's affiliates was the successful bidder accepted by the Metro District and was successful in securing the most competitive prices.

ARTICLE IX RESTORATION

9.1 Declarant Stores. If all or any portion of the Declarant Stores shall be damaged or destroyed by fire or other casualty, the Owner(s) of such Declarant Stores shall promptly commence the repair, replacement and rebuilding of the Declarant Store(s), or the portion thereof so damaged or destroyed, and shall diligently and continuously prosecute such repair, replacement and rebuilding in accordance with the terms of this Amended and Restated Declaration; provided, however, such Owner's obligation to repair, replace and rebuild such damage or destruction shall be limited to the lesser of: (1) ninety percent (90%) of the square feet of Floor Area in the Declarant Stores, as initially constructed; or (2) the maximum square feet of Floor Area as then permitted by applicable governmental/regulatory authority.

9.2 Common Area. In the event of damage or destruction of any Common Area improvement erected or placed on any Parcel (including the Metro District Parcel), whether by fire or other casualty, the Owner of such Parcel agrees to take all such action as may be required under applicable municipal ordinances and other laws, rules and regulations with respect to any such damage or destruction and to promptly

remove all debris resulting from such damage or destruction and commence, in accordance with Section 9.4 below, to repair, replace and rebuild such damaged Common Area. In the event of damage or destruction of any Common Area improvement on the Metro District Parcel, unless by agreement through a direct maintenance contract with the Metro District, Declarant warrants that all requirements of this Section 9, and Section 9.4 shall be met with respect to the Metro District Parcel, regardless of the cause of the damage, including without limitation, a party under an oil or gas lease or the holder of a mineral or water right caused in the process of extracting the same.

9.3 Duty to Commence and Complete Rebuilding. Subject to Sections 9.1 through 9.3, each Owner agrees to commence any required repair, replacement and rebuilding within six (6) months after such damage or destruction, or sooner if possible, and thereafter use due diligence in order to cause any building or other improvement which such Owner is required to repair, replace and rebuild pursuant to this Article to be completed and ready for occupancy within twelve (12) months after such damage or destruction occurs or as soon thereafter as is practicable under the circumstances, so long as such repair, replacement and rebuilding is diligently and continuously carried to full completion. Each Owner agrees that prior to commencing any such repair, replacement and rebuilding, such Owner shall comply with the requirements set forth in Article III of this Amended and Restated Declaration and other applicable provisions of this Amended and Restated Declaration with respect to construction, except as to any such requirement that may be modified under this Article. All such repaired, replaced, and rebuilt Stores, Common Area and other improvements shall be repaired, replaced, and rebuilt to as good a condition, to the same general appearance, and on the same level or story as the Store, Common Area and other improvements were immediately prior to such damage or destruction.

9.4 Clearing of Premises. Whenever an Owner is not required to repair, replace or rebuild and elects not to repair, replace and rebuild its Store(s) that has or have been damaged or destroyed, such Owner, at its sole cost and expense, shall raze such Store(s) or such part thereof as has or have been damaged or destroyed, clear the premises of all debris, and all areas not restored to their original use shall, at the expense of such Owner, be leveled, cleared and improved with parking area of like standard and design as the Common Area of the Shopping Center unless otherwise approved by Declarant. Although no transfer of ownership shall be deemed to have occurred as a result of such Owner's election not to repair, replace and rebuild its Store(s), said area shall be treated as Common Area and shall be maintained and insured by Declarant as such with such costs of maintenance and insurance being Common Area Expenses until such time as said Owner may elect to rebuild thereon. In connection with Declarant's maintenance of such unrestored area, Declarant and Declarant's employees, agents and contractors are hereby granted a license by such Owner to enter onto such unrestored area in connection with the maintenance thereof in accordance with this Amended and Restated Declaration.

ARTICLE X TERM

10.1 Term. This Amended and Restated Declaration and each term, easement, covenant, restriction and undertaking of this Amended and Restated Declaration shall be effective for a term ("Term") commencing as of the date hereof and shall terminate on the earlier of (1) June 1, 2065, (2) such date as the Owners may elect by written notice of termination executed by all of the owners and recorded in the

Official Records, or (3) such earlier termination as provided pursuant to and in accordance with this Amended and Restated Declaration (the "Expiration Date"); provided, however, that the Term may, as provided in the succeeding sentence, be extended beyond such Expiration Date for a maximum of three (3) independent ten (10) year terms (each, an "Extended Term") (for a total of thirty (30) years beyond the initial Term); provided, further, that no such expiration or termination shall affect the provisions and easements hereof that by their Term survive expiration. The Owner of the Control Parcel may, prior to the expiration of the Term or then Extended Term (as applicable), deliver notice to the other Owners indicating that such Electing Owner elects to extend the Term of this Amended and Restated Declaration for the next succeeding Extended Term. In such event, such Electing Owner shall unilaterally record a statement or other notice with the Official Records indicating such election to extend the Term of this Amended and Restated Declaration (with such statement or notice to include evidence that such Owner elected to extend the Term of this Amended and Restated Declaration as provided herein) within thirty (30) days of the expiration of the Term or then Extended Term (as applicable). In the event a statement or other notice is not filed with the Official Records within such thirty (30) days' time period, this Amended and Restated Declaration shall be deemed terminated. The following terms shall survive the termination of this Amended and Restated Declaration and shall continue in perpetuity: (i) Section 4.8 above; (ii) prohibition against obstructions in Section 4.4 above; (iii) compliance with law's requirement in Article VI above; (iv) the rights and easements set forth in Article II above; and (v) the hazardous and toxic materials provision of Article XVI below.

ARTICLE XI **EMINENT DOMAIN**

11.1 Awards to each owner. As between the Owners, any damage or other award resulting from or arising out of a condemnation or other taking for public or quasi-public purposes (a "Condemnation") of all or any portion of such Owner's Parcel(s) shall belong to such Owner without deduction therefrom for any present estate or interest of any other Owners and such other Owners hereby assign to the Owner whose Parcel was subject to the Condemnation all of such other Owner's right, title and interest in and to such damages or awards. This provision shall not act to prevent any other Owner from filing for or recovering its own separate award for any loss related to its Parcel and/or Store.

11.2 Parking Areas. If any portion of the Parking Area within the Shopping Center shall be taken by Condemnation with the result that the Shopping Center or any Parcel thereof is not thereafter in compliance with the parking requirements of this Declaration, Declarant, after the Metro District's receipt of any Condemnation award or damages resulting therefrom or equitably attributable thereto (the "Allocable Awards"), shall be authorized to promptly use all of said Allocable Award to create, to the extent reasonably possible, additional surface parking facilities in the Shopping Center in order that the Shopping Center will comply with the parking ratio required by this Declaration. First priority shall be to create additional surface parking facilities as close as possible to the Parcel or Parcels which are subject to the Condemnation. Notwithstanding the foregoing, Declarant shall have no obligation to restore Parking Area unless the Owner of the Parcel on which such Parking Area is to be restored approves of the location and configuration of the Parking Area to be restored and no Owner shall be obligated to provide or permit additional Parking Area upon its Parcel in case of a Condemnation of Parking Area contemplated by this Section 11.2, unless such Owner has given its consent to the location and layout thereof, if the Parking Area so taken by Condemnation was not contained within such Parcel of the Owner at issue. In the event

that there is not enough usable land available to restore surface parking facilities to comply with the required parking ratio, all Owners shall negotiate in good faith in an effort to agree upon an area within the Shopping Center where a parking deck could be constructed so as to replace the Parking Area lost by Condemnation, and if the Owners are able to reach such Agreement (as well as agreement on the precise location, design and cost of such parking deck), each Owner shall make available to Declarant any Allocable Award paid to such Owner with respect to Condemnation of its Parking Area (to the extent not utilized for provision of replacement surface Parking Area as aforesaid) and Declarant thereafter shall construct the parking deck so agreed upon, so long as same is allowed by applicable law under the circumstances, in order to comply with the required parking ratio; provided that Declarant shall have no obligation to construct any such Parking Deck if the cost to Declarant of constructing same (both "hard costs" and "soft costs") shall be in excess of the amount of the Allocable Awards paid to Declarant or the Metro District, as reasonably determined by Declarant, unless agreement likewise is reached among the Owners to provide for payment of the balance of the cost of such parking deck by the Owners over and above the Allocable Awards. In the event that the Allocable Awards shall be insufficient to completely restore the amount of parking required to comply with the parking ratio set out in Section 4.7 (and if the Owners have not hereafter agreed to fund the excess costs as contemplated herein), then the parking ratio set out in Section 4.7 shall be reduced to a ratio as near as possible to the requirements of Section 4.7 without the necessity for the Declarant's expenditure of any additional funds. If the Condemnation damages or award attributable to the Parking Area within a Parcel are not expended by Declarant to create additional surface parking facilities, and Declarant, within 120 days following Declarant's receipt of such damages or award, shall not have committed to construct a Parking Area as provided above, the Condemnation damages or award shall be returned to the Owner of such Parcel subject to Condemnation.

11.3 Declarant's Participation. Neither Declarant, nor its affiliates, nor any of their directors, officers, partners, members, shareholders, employees, representatives and/or agents shall directly or indirectly initiate, instigate, encourage, recommend or direct, as opposed to defending or pursuing its rights in connection with, (collectively "Declarant's Participation") any Condemnation, eminent domain, taking, deed in lieu of condemnation or similar proceedings (collectively, "Taking"), of the whole or any part of the Shopping Center, or any right or interest therein or related thereto, Taking that will not materially and adversely interfere with the Protected Rights or the defense thereof. In the event that any Protected Rights are subject to a Taking, and such Protected Rights do not involve the Taking of actual soil or land (i.e., terra firma), if Declarant's Participation was involved in such Taking, Declarant, on behalf of itself and any successor Declarant, agrees to the extent pertaining to any Declarant Parcel to continue to be bound by, and honor, all of the provisions of this Declaration, respecting Protected Rights with regard to such Parcel, all without modification to address any such Taking, as if such covenants were personal covenants of the Owner of the Parcel at issue. For purposes hereof, Declarant's Participation shall not be deemed to prohibit Declarant from fully participating in the defense of any condemnation proceeding or the pursuit of any rights, remedies or awards available to Declarant pursuant to such condemnation.

ARTICLE XII
TRANSFER OR CONVEYANCE

12.1 **Transfer of Entire Interest.** In the event of the Transfer of the whole of the interest of any Owner in and to any Parcel(s) in which such Owner has an interest, without retaining any beneficial interest other than under the terms of a deed of trust or mortgage or without simultaneously acquiring a new interest by way of leasehold, life estate or other possessory interest, then the rights conferred upon such Owner shall be deemed Transferred and the obligations deemed assumed with its interest by such Transferee. A Transfer by a Related Corporation is not considered a Transfer for purposes of this section.

12.2 **Sale Leaseback.** In the event the whole of the interest of such Owner in and to the Parcel in which it has an interest is Transferred, but a new interest is created in such Owner simultaneously with such transfer by way of leasehold or similar possessory arrangement (i.e., a Sale and Leaseback or Assignment and Sub-leaseback), or in the event such Owner shall Transfer its interest in said Parcel or any part thereof by deed of trust or other security instrument as security for indebtedness, then none of the rights or obligations conferred upon such Owner with regard to the interest Transferred shall be transferred by such Owner by virtue of the transaction at issue, but all of the rights and obligations of such Owner shall remain in such Transferor Owner so long as it retains any possessory interest in and to said Parcel other than as a beneficiary under the terms of a deed of trust or mortgage. In the event the interest of such Owner shall cease and terminate, then upon such termination the rights and obligations (to the extent thereafter to be performed) of such Owner shall vest in the Transferor Owner's successor Transferee in accordance with this Article (but such Transferee, in such event, shall not be personally liable for the performance of any term, covenant, obligation or condition as to any matter which arose prior to the Transfer).

12.3 **Multiple Ownership.** In the event there shall be more than one record owner comprising the Owner of a Parcel ("Co-Owners"), then not less than fifty-one percent (51%) in interest of such Co-Owners shall designate one of their number to act on behalf of all of such Co-Owners in the exercise of the rights granted to an owner under this Amended and Restated Declaration. So long as such designation remains in effect, such designee shall be the Owner hereunder and shall have the power to bind such Parcel and such Co-Owners, and such Co-Owners shall not be deemed to be Owners. Any such designation must be in writing and served upon the other Owners by registered or certified mail and must be recorded in the Official Records. In the absence of such written designation, the acts of the Owner whose interest is so divided with respect to the exercise of the rights vested by this instrument shall be binding upon all Co-Owners until such time as written notice of such designation is given and recorded in the Official Records. All Co-Owners shall be jointly and severally liable with respect to all the terms, obligations, covenants, and conditions under this Amended and Restated Declaration during their period of ownership (subject to Section 12.4 below).

12.4 **Release.** Whenever the rights and obligations conferred upon any of the Owners are vested in another Owner or Owners pursuant to the provisions of this Article, the Transferor shall be released or discharged from the obligations thereafter accruing under the terms of this Amended and Restated

Declaration, and the Transferee(s) of such interest shall be bound by the covenants and restrictions herein contained, subject to the terms herein. Notwithstanding the foregoing, no such Owner shall be so released until notice of such Transfer has been given in the manner set forth below, at which time the Transferring owner's personal liability for unaccrued obligations shall terminate. An Owner transferring all or any portion of its interest in the Shopping Center shall give notice to the other Owners of such Transfer and shall include therein at least the following information: (i) the name and address of the new Owner; (ii) a copy of the legal description of the portion of the Shopping Center so Transferred; and (iii) a copy of the instrument evidencing such Transfer and the assumption by the Transferee as provided herein. Until notice of such Transfer is given, the Transferring Owner shall (for purposes of this Amended and Restated Declaration only) be the Transferee's Agent.

ARTICLE XIII TAXES

13.1 **Calculation and Payment of Real Property Taxes.** To the fullest extent possible, real estate taxes and general and special assessments (collectively, "Real Property Taxes") levied and assessed against any Owner's Parcel and any Store or other improvements thereon, shall be separately assessed by the taxing authority and all Owners shall cooperate reasonably with Declarant and each other as needed to have separate tax parcel status given to each Parcel hereunder; provided, however, that nothing herein shall require Declarant to obtain separate tax assessments for any Parcel, Store or other improvements. Each Owner shall pay or cause to be paid all such Real Property Taxes levied and assessed on its Parcel and any Store or other improvements thereon, except as otherwise provided herein. Such Real Property Taxes shall be paid in installments where installments are permitted by Separate Agreement with Declarant. Declarant shall pay all Real Property Taxes before all interest, penalties, late charges, and lost discount amounts are incurred. In the case of such joint assessment, the Owner of each Parcel shall be responsible for a share of the Real Property Taxes assessed and applicable solely to such Owner's Parcel, as determined by reference to the records of the applicable taxing authority, including, without limitation, any work sheets and other documents compiled by the assessor. In the event it is not possible in such fashion to determine the specific Real Property Taxes applicable to each such Parcel by reference to the foregoing records, each Owner shall pay its proportionate share of the Real Property Taxes at issue, calculated as follows: (i) as to any Real Property Taxes assessed against land, each Owner shall pay such Owner's proportionate share of the Real Property Taxes assessed against the land comprising the larger parcel based on a fraction, the numerator of which shall be the number of acres (to the nearest 1/100th of an acre) in the Parcel at issue and the denominator of which shall be the total number of acres in the aggregate of all Parcels assessed in such tax bill (to the nearest 1/100th of an acre); and (ii) as to any Real Property Taxes assessed against buildings, each Owner shall pay such Owner's fair and equitable share of the Real Property Taxes assessed against all the buildings of the jointly assessed Parcels, as reasonably determined by Declarant, which share shall be consistent with the assessed value of the building(s) on the Parcel at issue (if such value is available) or the assessed value of similarly situated buildings in Weld County, Colorado to the extent the actual assessed value of the building(s) is not available. To the extent that the Metro District Parcel is subject to Real Property Taxes, Declarant agrees to pay such Real Property Taxes.

13.1 **Personal Property Taxes.** In addition to Real Property Taxes, each Owner shall cause to be paid before delinquency all taxes (including sales and use taxes), assessments, license fees and public charges

levied, assessed or imposed upon the business operations on its Parcel(s) as well as upon the merchandise, inventory, furniture, fixtures, equipment and other personal property of such businesses. In the event any such items of property of any Owner other than Declarant are assessed with property of Declarant, such assessment shall be equitably divided between Declarant and such other Owner by Declarant, after consultation with such other Owner, in which case the other Owner shall be responsible to pay the taxes appropriately allocated to it.

ARTICLE XIV
INDEMNIFICATION AND INSURANCE

14.1 Indemnity - Common Area. Declarant shall indemnify, defend and hold harmless the other Owners from and against all claims and all costs, expenses, and liabilities (including reasonable attorneys' fees), damages and liabilities incurred in connection with such claims, including any action or proceedings brought thereof, arising from or as a result of the death of or any accident, injury, loss or damage whatsoever caused to any Person or to the property of any Person as may occur on or about the Common Area that is maintained by Declarant pursuant to Section 8.1 by reason of an occurrence or condition on such Common Area; provided, however, an Owner shall not be entitled to such indemnity for any claims, death, accidents, injuries, loss or damages arising from or as a result of the negligent or willful act or omission of such Owner or its agents, servants, employees or contractors, including the failure of such owner to maintain the Common Area on its Parcel if such obligation has been delegated to such Owner hereunder.

14.2 Indemnity - Parcels. Each Owner shall indemnify, defend and hold harmless the other Owners from and against all claims and all costs, expenses, and liabilities (including reasonable attorneys' fees), damages and liabilities incurred in connection with such claims, including any action or proceedings brought thereof, arising from or as a result of: (i) the death of or any accident, injury, loss or damage whatsoever caused to any Person or to the property of any Person as may occur on or about such Owner's Parcel (except those portions of such Owner's Parcel that are Common Area that is maintained by Declarant pursuant to the terms of this Amended and Restated Declaration), by reason of an occurrence or condition on such Owner's Parcel or the improvements which may be constructed thereon or (ii) a negligent or willful act or omission of the indemnifying Owner, its agents, servants, employees or contractors; provided however, in each case referred to in (i) and (ii) above, an owner shall not be entitled to such indemnity for any claims, death, accidents, injuries, loss or damages arising from or as a result of the negligent or willful act or omission of such Owner or its agents, servants, employees or contractors.

14.3 Casualty Coverage. In order to assure performance of their respective obligations under this Amended and Restated Declaration, it is agreed that commencing as of the date any Owner (or the District) commences construction with respect to its respective Parcel(s) and thereafter for the Term of this Amended and Restated Declaration, such Owner (or the District) shall carry property insurance on an all risk basis on its respective Store(s) in an amount sufficient to avoid the effect of any coinsurance provisions of such policies and in any event in an amount not less than the full replacement value of such Store(s) excluding, in each case, foundation, footing and excavation costs, with reasonable deductibles, and otherwise in accordance with the requirements set forth in this Article. Operator shall maintain or cause to be maintained property insurance on an all-risk basis covering the Common Area in an amount not less than the full

replacement value of said Common Area, otherwise in accordance with the requirements set forth in this Article. All such insurance shall be carried with financially responsible companies authorized to do business in the State of Colorado and meeting the standards set forth in this Article. In the event the district does not cause the Metro District Parcel to meet the insurance standards set forth in this Article, then Declarant shall cause the Metro District Parcel to meet the insurance standards set forth in this Article.

14.4 Liability Coverage. Each Owner (or the District) shall carry (or cause to be carried) with insurance companies authorized to do business in the State of Colorado, commercial general liability insurance written on an occurrence basis covering its legal liability in connection with claims for personal injury or death and property damage incurred upon or about its Parcel(s) and within any Store(s) constructed on its Parcel(s) in accordance with the requirements of this Article; provided, however, that so long as Declarant (or Operator as applicable) is obligated to maintain the Common Area pursuant to the terms of this Amended and Restated Declaration, no Owner other than Declarant shall be required to maintain such liability insurance on any portion of the Common Area located on such Owner's Parcel. Similarly, Declarant shall carry (or cause to be carried) with insurance companies authorized to do business in the State of Colorado, commercial general liability insurance written on an occurrence basis covering legal liability for claims for personal injury or death or property damage incurred upon or about the Common Area in accordance with the requirements of this Article. Declarant shall be shown as an additional insured on each owner's commercial general liability insurance for personal injury or death and property damage incurred upon or about its Parcel. All such commercial general liability insurance shall have minimum limits in Constant Dollars, of \$1,000,000.00 per occurrence, with an annual aggregate limit of \$2,000,000.00 for personal or bodily injury and damage to property, and an umbrella policy with an annual aggregate limit of \$5,000,000.00. In the event the district does not cause the Metro District Parcel to meet the insurance standards set forth in this Article, then Declarant shall cause the Metro District Parcel to meet the insurance standards set forth in this Article.

14.5 Insurance Requirements. All policies of insurance required under this Article shall be issued by reputable insurance companies. Certificates of such policies shall be delivered to any Owner requesting the same promptly after the request by any other Owner. As often as any such policy shall expire or terminate, renewal or additional policies shall be procured and maintained by the Owner responsible for the same in a like manner and to like extent. All commercial general liability and property damage policies shall be written as primary policies, not contributing with or secondary to coverage which the other Owners may carry. Declarant may require that increased amounts of insurance be required to be carried by any Owner pursuant to this Amended and Restated Declaration and that such Owner also carry other reasonable types of insurance coverage in such reasonable amounts as may be determined by Declarant to be appropriate; provided, however, no such increases or additional coverages shall be required more than once in every five (5) year period. Further, in no event shall (i) such increased amounts of insurance or such other types of insurance be in excess of that required by prudent Declarants of first comparable first class shopping centers in the state of Colorado and (ii) such coverage include terrorism, earthquake and flood coverage unless such coverage is required by Declarant's lender (if applicable) and is customarily carried by similarly situated tenants in Colorado and is available at commercially reasonable rates as reasonably determined by the Owner being required to carry such additional coverage.

14.6 Waiver of Subrogation. Each Owner (the "Waiving Owner"), by accepting a deed to its Parcel, shall be deemed to have waived any rights the Waiving Owner may have against the other Owners (including but not limited to a direct action for damages) on account of any loss or damage suffered by the Waiving Owner (whether or not such loss or damage is caused by the fault, negligence or other tortious conduct, acts or omissions of the other Owners or their respective officers, directors, employees, agents, contractors or invitees), to its property, Parcel and the improvements thereon, its contents or to any other portion of the same arising from any risk covered by or which could be covered by the forms and type of property insurance required to be carried by the Owners, respectively, under Section 14.3 of this Amended and Restated Declaration. Each Waiving Owner further, on behalf of its insurance companies insuring the property of such Waiving Owner against any such loss, waives any right of subrogation that such Waiving Owner or its insurers may have against the other Owners or their respective officers, directors, employees, agents, contractors or invitees and all rights of their respective insurance companies based upon an assignment from its insured. Each Owner shall give each such insurance company written notification of the terms of the mutual waivers contained in this Section and have said insurance policies properly endorsed, if necessary, to prevent the invalidation of such insurance coverage by reason of said waivers. The foregoing waiver shall be effective whether or not the Owners maintain the required insurance or give written notice of the waivers contained herein to their insurance companies. The provisions of this Section 14.6 are further subject to the provisions and limitations of Section 14.8 below.

14.7 Use of Proceeds. Except as otherwise provided herein, any loss covered by the insurance required to be carried by an Owner under Section 14.3 shall be adjusted with and paid by the insurance company by and to such Owner and upon receipt thereof, if the loss is in excess of \$500,000, the proceeds shall be deposited in a bank, trust or title company (selected by the respective Owner but approved by the Declarant) having an office in Johnstown, Colorado, to be held in trust or escrow to be paid out for the purpose of repair, replacement or rebuilding of the damaged premises as provided in this Amended and Restated Declaration; provided, however, in the event such Owner is not obligated to repair, replace or rebuild the damaged premises in accordance with Article IX, then the insurance proceeds shall be paid directly to Owner and shall not be required to be deposited in a bank, trust or title company. Upon presentation to the trustee or escrowee of proper material and labor bills and applicable lien waivers for such work completed and an architect certificate for completed work approving payment of such bills, the trustee or escrowee shall, as the work progresses, pay the amount of such bills to the persons, firms or corporations rendering or furnishing such labor, services, or materials. After completion of the repair, replacement or rebuilding and after such bills in connection with such work have been paid in full, any remaining balance of the proceeds of such insurance shall be released and paid over by said trustee or escrowee to the Owner whose premises were so damaged. The Owner whose premises were so damaged agrees to pay all reasonable fees and charges made by the trustee or escrowee for acting as trustee or escrowee hereunder. In the event of a loss in the amount of \$500,000 or less, the proceeds shall be paid in trust to the Owner whose premises were so damaged, which proceeds shall be applied to the cost of the repair, replacement or rebuilding of such premises. The Owner for whose benefit any property insurance is carried shall be responsible for and pay the cost of repair, replacement or rebuilding not covered by such insurance proceeds, including inadequate coverage and the amount of any deductibles.

14.8 Additional Insurance Requirements. Anything herein to the contrary notwithstanding, it is understood and agreed that the policy or policies providing the insurance which the Owners are obligated to maintain under the terms of Section 14.3 may be made payable to the holder of any first mortgage of

the respective Owner' s interest in the Shopping Center under a standard mortgagee clause, provided such Mortgagee agrees that it will, in the event of loss, hold the proceeds for payment of the costs of the repair, replacement or rebuilding (to the extent required under Article IX above) pursuant to the provisions of Section 14.7, as if it were the trustee thereunder.

14.9 **Blanket Insurance.** Any insurance required to be carried pursuant to this Article may be carried under a policy or policies covering other liabilities and locations of an owner; provided, however, that such policy or policies apply to the properties required to be insured by this Article in an amount not less than the amount of insurance required to be carried by such Owner, with respect thereto, pursuant to this Article.

ARTICLE XV **DEFAULT AND REMEDIES**

15.1 **Notice and Cure.** A default shall occur under this Amended and Restated Declaration if any Owner (a Defaulting Owner) shall fail to perform any of the terms, provisions, covenants or conditions to be performed or complied with by the Defaulting Owner pursuant to this Amended and Restated Declaration and any such failure shall remain uncured for a period of thirty (30) days after any other owner (the "Non-Defaulting Owner") shall have served upon the Defaulting Owner written notice of such failure; provided that no default shall occur if: (i) the default is of such character as reasonably to require more than thirty (30) days to cure and the Defaulting owner shall commence to cure such default within said thirty (30) day period and shall continuously and diligently prosecute such cure to completion after commencing such cure or (ii) a separate notice and remedy provision is specifically provided elsewhere in this Amended and Restated Declaration for such default and the Defaulting Owner complies with and cures under said provision. Notwithstanding the foregoing, if the failure of the Defaulting Owner relates to a matter which is of an emergency nature involving immediate threat of damage or injury to persons or property then (x) the Non-Defaulting Owner, at its option, may perform any such term, provision, covenant, or condition, or make any such payment required to cure such emergency, provided that the Non-Defaulting Owner provides the Defaulting Owner with notice of such failure within 48 hours after the Non- Defaulting Owner discovers the same, (y) the Defaulting Owner shall promptly reimburse the Non-Defaulting Owner for all such expenses and costs incurred, and (z) the Non-Defaulting Owner shall not be liable or responsible for any loss or damage resulting to the Defaulting owner or anyone holding under or through the Defaulting Owner on account of such cure.

15.2 **Default Interest.** Interest shall accrue on sums owed by a Defaulting owner to a Non-Defaulting Owner and shall be payable from the date any such sum first became due hereunder until paid in full, at a rate of interest (the "Default Rate") equal to the lesser of: (a) the floating rate which is equal to five percent (5%) per annum in excess of the annual rate of interest from time to time published in the Wall Street Journal as the Prime Rate or (b) the then maximum lawful rate of interest in Colorado applicable to the capacity of the Defaulting Owner and the nature of the debt.

15.3 **Additional Remedies.** Each Owner shall have and is hereby granted a non-exclusive right of entry and non-exclusive easements for and during the Term of this Amended and Restated Declaration, in, over and under the Parcels of any other Defaulting Owner (excluding the right to enter any buildings or Stores thereon) for all purposes reasonably necessary, to enable the Non-Defaulting Owner (acting directly or

through agents, contractors or subcontractors) to perform any of the terms, provisions, covenants or conditions of this Amended and Restated Declaration on the part of the Defaulting Owner to be performed. In the event of a breach, or attempted or threatened breach, of any terms, provisions, covenants or conditions of this Amended and Restated Declaration, the Non-Defaulting Owner shall be entitled forthwith to full and adequate relief by injunction, damages, and all other available legal and equitable remedies from the consequences of such breach.

ARTICLE XVI
HAZARDOUS AND TOXIC MATERIALS

From the date of this Amended and Restated Declaration, each Owner shall be responsible as to its respective Parcels, and as to all Stores and other improvements thereon, with respect to hazardous and toxic materials, to comply with the following:

16.1 **Hazardous Material.** Except as to items commonly sold or used in sporting goods stores or Stores having other uses permitted herein (and which are used, stored, handled and disposed of in material compliance with Environmental Laws then in effect), no Owner shall keep, store, produce, permit to be kept, stored or produced, on or about such Owner's Parcel or any improvements thereon, for use, disposal, treatment, generation, storage or sale, any substance designated as, or containing components designated as hazardous, dangerous, toxic or harmful or which may be considered a Hazardous Material and/or is subject to regulation by any Environmental Law and/or other federal, state or local law, regulation, statute or ordinance now or hereinafter enacted. In addition, the Owners agree not to release or discard any Hazardous Materials on said Owner's Parcel, or any other Parcel within the Shopping Center. Notwithstanding the foregoing, Owners may store, handle and use the following chemicals, substances or materials if they are used, stored, handled and disposed of in material compliance with Environmental Laws then in effect: (i) chemicals, substances or materials routinely used in office areas; (ii) janitorial supplies, cleaning fluids or other chemicals, substances or materials reasonably necessary for the day-to-day operation or maintenance of the Owner's business and property or the business of any lessee of an Owner, (iii) chemicals, substances, or materials reasonably necessary for the construction or repair of improvements on owner's Parcel and (iv) fuel or other substances used in connection with a back-up electrical generator system. For so long as an Owner is the owner of its respective Parcel, such Owner shall, at such Owner's sole cost and expense, promptly comply with all Environmental Laws and/or other laws and ordinances and the orders, rules and regulations and requirements of all federal, state and municipal governments and appropriate departments, commissions, boards, and officers thereof, and the orders, rules and regulations of the Board of Fire Underwriters where the Parcel is situated, or any other body now or hereafter constituted exercising similar functions, foreseen or unforeseen, ordinary as well as extraordinary, and whether or not the same require structural repairs or alterations, which may be applicable to the Parcel or any improvements thereon, or the use or manner of use of such Parcel or improvements. Each Owner shall likewise observe and comply with the requirements of all policies of public liability, fire, and all other policies of insurance at any time in force with respect to the Parcel, the improvements and equipment on the parcel or in the improvements. In addition, each Owner, at its cost and expense, shall comply with all laws, statutes, ordinances, rules, and regulations of any governmental authority ("Agency") having jurisdiction thereof concerning environmental matters, including, but not limited to, any discharge into the air, waterways, sewers, soil or ground water of any substance or "pollutant". Upon prior reasonable notice

and at times reasonably acceptable to such Owner, Declarant and its agents and representatives shall have reasonable access to each Owner's Parcel and any improvements thereon for the purpose of ascertaining the nature of the activities being conducted thereon and to determine the type, kind and quantity of all products, materials and substances brought onto the Parcel(s) or any improvements thereon or made or produced thereon and if Declarant or its agents shall in their inspection of the Parcel(s), damage the property, then they shall restore the property to its prior condition. Each Owner and all occupants of the Parcel or any improvements thereon claiming under Owner shall provide to Declarant copies of all manifests, schedules, correspondence and other documents of all types and kinds when filed or provided to an Agency or otherwise required to be maintained by an Agency or as such are received from any Agency. Declarant and its agents and representatives shall have the right to take samples in quantity sufficient for scientific analysis of all products, materials and substances present on the Parcel(s) or in any improvements thereon, including, but not limited to, samples of products, materials or substances brought onto or made or produced on the Parcel(s) or in any improvement thereon by an Owner or an occupant claiming under an owner or otherwise present on the Parcel or any improvements thereon. If an Owner breaches the obligations stated in this paragraph, or if the presence of Hazardous Material on the Parcel or improvements thereon caused or permitted by an Owner results in contamination of the Parcel and/or improvements, or if contamination of the Parcel or improvements by Hazardous Material otherwise occurs for which such Owner is legally liable to Declarant or any other Owner for damage resulting therefrom, then such Owner shall indemnify, defend and hold Declarant and any other Owner harmless from any and all claims, judgments, damages, penalties, fines, costs, liabilities or losses (including, without limitation, sums paid in settlement of claims, attorneys' fees, consultant fees and expert fees) which arise during or after the period during which such owner is the owner of such Parcel as a result of such contamination. Any Owner who is asked to "defend" Declarant or another Owner shall have the right to select defense counsel. In the event the indemnified Owner desires to select its own counsel, it shall be at the indemnified Owner's sole expense and such defense shall be tendered immediately and in a manner that does not prejudice the rights of the indemnitor. Any indemnity under the provisions of this Section shall not apply to any claims brought separately against the indemnified Owner for a separate act or omission. This indemnification of Declarant and all other Owners by each Owner includes, without limitation, costs incurred in connection with any investigation of site conditions or any cleanup, remedial, removal or restoration work required by any federal, state, or local governmental agency or political subdivision because of Hazardous Material present in the soil or ground water on or under the respective Parcel. Without limiting the foregoing, if the presence of any Hazardous Materials on a Parcel caused or permitted by an Owner result in any contamination of the Parcel and/or improvements thereon, such contaminating Owner shall promptly take all actions at its sole expense as are required by applicable law to return the Parcel and/or improvements to the condition existing prior to the introduction of any such Hazardous Material. If a contaminating Owner does not promptly take such action to return the Parcel and for improvements to its/their prior condition as required, any other Owner shall have the right, but no obligation, to take such action as required by law to return the Parcel and for improvements at issue to their prior condition, immediately following notice to such contaminating Owner by such other Owner of its intent to take such action, and such contaminating Owner shall reimburse such other Owner for any costs incurred by such other Owner in connection therewith upon submission by such other Owner to said contaminating Owner of such costs.

ARTICLE XVII
MISCELLANEOUS

17.1 **Modification.** Declarant may amend, modify, discharge, waive, or change this Amended and Restated Declaration in its sole discretion; provided, however, that no such modification, waiver, amendment, discharge, or change shall impose any materially greater obligation on or materially impair any right of an Owner or its Parcel unless such Owner has joined in the execution of such document.

17.2 **Binding Effect.** All of the limitations, covenants, conditions, easements, and restrictions contained herein shall attach to and run with the Owners' Parcel and shall benefit or be binding upon the successors and assigns of the respective Owners. This Amended and Restated Declaration and all the terms, covenants and conditions herein contained shall be enforceable as equitable servitudes in favor of said Parcels and any portion thereof.

17.3 **Injunctive and Declaratory Relief.** In the event of any violation or threatened violation by any Permittee of the Shopping Center (or any portion thereof) of any of the terms, covenants, conditions, and restrictions herein contained, in addition to any other remedies provided for in this Amended and Restated Declaration, the Owners shall have the right to enjoin such violation or threatened violation and to bring an action for declaratory relief in a court of competent jurisdiction.

17.4 **Breach Shall Not Permit Termination.** It is expressly agreed that no breach of this Amended and Restated Declaration shall entitle any Owner to cancel, rescind, or otherwise terminate this Amended and Restated Declaration, and such limitations shall not affect in any manner any of the rights or remedies which the Owners may have by reason of any breach of this Amended and Restated Declaration.

17.5 **Subdivision.** Notwithstanding anything to the contrary contained in this Amended and Restated Declaration, no Owner, other than Declarant, shall have the right to further subdivide a Parcel or add additional land to its respective Parcel or to the Shopping Center.

17.6 **Effect on Third Parties.** The rights, privileges, or immunities conferred hereunder are for the benefit of the Owners and not for any third party.

17.7 **No Partnership.** Neither this Amended and Restated Declaration nor any acts of the Owners respecting performance under this Amended and Restated Declaration shall be deemed or construed by the Owners, or any of them, or by any third person, to create the relationship of principal and agent, or of partnership, or of joint venture, or of any association between or among any of the owners under this Amended and Restated Declaration.

17.8 **Severability.** In the event any term, covenant, condition, provision, or agreement contained herein is held to be invalid, void, or otherwise unenforceable, by any court of competent jurisdiction, such holding shall in no way affect the validity of enforceability of any other term, covenant, condition, provision, or agreement contained herein, each of which shall be enforced to the maximum extent permitted by law.

17.9 **Governing Law.** This Amended and Restated Declaration and the obligations of the Owners hereunder shall be interpreted, construed, and enforced in accordance with the laws of the State of Colorado.

17.10 **Terminology.** All personal pronouns used in this Amended and Restated Declaration, whether used in the masculine, feminine, or neuter gender, shall include all other genders; the singular shall include the plural and vice versa.

17.11 **Counterparts.** This Amended and Restated Declaration may be executed in multiple counterparts, each of which shall be deemed to be an original agreement, and all of which shall constitute one agreement.

17.12 **Captions.** Article and section titles or captions contained herein are inserted as a matter of convenience and for reference, and in no way define, limit, extend, or describe the scope of this Amended and Restated Declaration or any provisions hereof.

17.13 **Consent.** In any instance in which any Owner under this Amended and Restated Declaration shall be requested to consent to or approve of any matter with respect to which such Owner's consent or approval is required by any of the provisions of this Amended and Restated Declaration, such consent or approval or disapproval shall be given in writing, and shall not be unreasonably withheld, delayed or conditioned, unless the provisions of this Amended and Restated Declaration with respect to a particular consent or approval shall expressly provide otherwise.

17.14 **Estoppel Certificate.** Each Owner shall issue to a requesting owner (or to any Mortgagee, or any other Person reasonably specified by such requesting Owner), within thirty (30) days following written request of any such requesting Owner, an estoppel certificate stating:

- (i) whether the Owner to whom the request has been directed knows of any default under this Amended and Restated Declaration of any other Owner, and if there are known defaults, specifying the nature thereof;
- (ii) whether to its knowledge this Amended and Restated Declaration has been assigned, modified, or amended in any way (or if it has, then stating the nature thereof);
- (iii) that to the Owner's knowledge this Amended and Restated Declaration as of that date is in full force and effect (or, if such be not the case, the qualifications respecting such statement).

Such statements shall not subject the Owner furnishing it to any liability, notwithstanding the negligent or otherwise inadvertent failure of such owner to disclose correct and/or relevant information. However, the Owner furnishing the certificate shall not be entitled to assert or enforce any claim against the Person to whom it is issued (or against such Person's property) which is contrary to the statements contained in the certificate and such person acted in reasonable reliance upon such statement, except to the extent that the Person against whom the claim would be asserted had actual knowledge of facts to the contrary. Any Owner who is requested to give an estoppel under this Section may require, as a condition of its obligation to give the estoppel that the Owner on whose behalf the original request was made gives a similar estoppel to the Owner requested to give an estoppel. Notwithstanding the forgoing, (i) any estoppel certificate to be delivered by Declarant may be limited to the actual knowledge of the corporate officer or officers of Declarant, without any investigation or duty to investigate,

17.15 **Time of Essence.** Time is of the essence with respect to the performance of each of the covenants and agreements contained in this Amended and Restated Declaration.

17.16 **Entire Agreement.** This Amended and Restated Declaration and the exhibits hereto contain all the entire agreement of Declarant with respect to the subject matter hereof. Any prior correspondence, memoranda or agreements are superseded in total by this Amended and Restated Declaration and Exhibits hereto. The provisions of this Amended and Restated Declaration shall be construed as a whole according to their common meaning and not strictly for or against any Owner.

17.17 **Excuses for Non-Performance.** Each Owner shall be excused from performing any obligation or undertaking provided in this Amended and Restated Declaration, except any obligation to pay any sums of money under the applicable provisions hereof, in the event and so long as the performance of any such obligation is prevented or delayed, retarded or hindered by act of God, fire, earthquake, floods, explosion, actions of the elements, war, invasion, insurrection, riot, mob violence, sabotage; inability to procure or general shortage of labor, equipment, facilities, materials or supplied in the ordinary course on the open market; failure of normal transportation; strikes, lockouts, action of labor unions; condemnation, requisition; laws or orders of governmental or civil or military authorities; breach or default of any other Owner of any of its obligations hereunder; failure to obtain necessary governmental approvals or permits despite the exercise of due diligence and good faith efforts by an Owner, or any other cause, whether similar or dissimilar to the foregoing, not within the reasonable control of such Owner, other than the lack of or inability to obtain funds or causes which were reasonably foreseeable (collectively, "Unavoidable Delays").

17.18 **Waiver of Default.** No waiver of any default by any Owner to this Amended and Restated Declaration shall be implied from any omission by any other Owner to take any action in respect of such default if such default continues or is repeated. No express written waiver of any default shall affect any default or cover any period of time other than the default and period of time specified in such express waiver. One or more written waivers of any default in the performance of any term, provision or covenant contained in this Amended and Restated Declaration shall not be deemed to be a waiver of any subsequent default in the performance of the same term, provision or covenant or any other term, provision or covenant contained in this Amended and Restated Declaration. The consent or approval by any Owner to or of any act or request by any other Owner requiring consent or approval shall not be deemed to waive or render unnecessary the consent to or approval of any subsequent similar acts or requests. The rights and remedies given to any Owner by this Amended and Restated Declaration shall be deemed to be cumulative and no one of such rights and remedies shall be exclusive of any of the others, or if any other right or remedy at law or in equity which any such Owner might otherwise have by virtue of a default under this Amended and Restated Declaration, and the exercise of one such right or remedy by any such Owner shall not impair such Owner's standing to exercise any other right or remedy.

17.19 **Other Tenancies.** Subject to the terms of this Amended and Restated Declaration, Declarant reserves the right to affect such tenancies in the Shopping Center as Declarant in the exercise of its sole business judgment shall determine to best promote the interests of the Shopping Center.

17.20 **Declarant Exculpation.** Notwithstanding anything in this Amended and Restated Declaration to the contrary, and notwithstanding any applicable law to the contrary, the liability of Declarant hereunder (including any successor Declarant hereunder) and any recourse by any Owner against Declarant shall be

limited solely and exclusively to the interest of Declarant in and to the Shopping Center at the time, and neither Declarant, nor any of its constituent partners, sub partners, members, managing members or agents, shall have any personal liability therefor, and each other Owner, on behalf of itself and all persons claiming by, through or under such Owner, hereby expressly waives and releases Declarant and such partners, sub partners, members, managing members or agents from any and all personal liability.

17.21 **Continuous Operation.** In no event shall Declarant have any liability hereunder whatsoever for the failure of any subsequent Owner or Permittee of any Parcel to continuously operate and Declarant has made no representation herein whatsoever that any tenant or Parcel Owner will continuously operate. Nothing herein contained, however, shall be interpreted to affect or otherwise change any agreement between Declarant and any other Owner.

17.22 **Exhibits.** The following exhibits are attached to this Amended and Restated Declaration and hereby incorporated herein:

- EXHIBIT A-1: Legal Description of Declarant's Property and Parcel(s)
- EXHIBIT A-3: Legal Description of Metro District's Property and Parcel(s)
- EXHIBIT A-4: Legal Description of the Control Parcel
- EXHIBIT B : Site Plan
- EXHIBIT B-1: Site Plan with Access Roads
- EXHIBIT B-4: Plat with Control Parcel

ARTICLE XVIII **RULES AND REGULATIONS**

Declarant (and any other Owner to the extent applicable herein) shall not be responsible for the violation or nonperformance by any other Permittee of the Shopping Center with regard to these Rules and Regulations (the "Rules and Regulations"); provided, however, that Declarant (and any other Owner to the extent applicable herein) agrees to use its commercially reasonable efforts to cause such Permittee to comply with these Rules and Regulations.

18.1 **Common Areas.** In addition to any other requirement in this Declaration, the Common Areas shall be maintained consistent with the following rules and regulations:

- (a) The surface of the sidewalks shall be maintained level, smooth, and evenly covered with the type of surfacing material originally installed thereon, or such substitute thereof that shall be in all respects equal thereto in quality, appearance, and durability;
- (b) All papers, debris, filth, and refuse shall be removed from the Shopping Center, and paved areas shall be washed or thoroughly swept as required;
- (c) All trash and rubbish containers located in the Common Area for the use of Permittees shall be emptied on a sufficiently regular basis. In the event Declarant does not provide a trash hauler for the Shopping Center, Declarant shall have the right to reasonably approve of any and all trash haulers contracted by Permittees and to reasonably approve of the hours of pick-up;

- (d) All landscaping shall be properly maintained, including removal of dead plants, weeds, and foreign matter and such replanting and replacement as the occasion may require;
- (e) All hard-surfaced markings shall be inspected at regular intervals and promptly repainted as the same shall become unsightly or indistinct from wear and tear, or other cause;
- (f) All storm drain catch basins shall be cleaned on a schedule sufficient to maintain all storm drain lines in a free-flowing condition and all mechanical equipment related to storm drain and sanitary sewer facilities shall be kept in proper working order;
- (g) All asphalt paving shall be maintained in a first-class condition;
- (h) All surface utility facilities servicing the Common Areas shall be promptly repaired or replaced, as the occasion may require, upon the occurrence of any defect or malfunctioning;
- (i) All Common Area amenities, benches, and institutional, directional, traffic, and other signs shall be maintained in a clean and attractive surface condition and promptly repaired or replaced upon the occurrence of any defect or malfunctioning;
- (j) All lamps shall be promptly replaced when no longer properly functioning; and
- (k) The Owners shall use their diligent efforts to require their respective Permittees to comply with all regulations with respect to the Common Area, including, but not by way of limitation, posted speed limits, directional markings, and parking stall markings.

18.2 Floor Areas. In addition to any other requirement in this Amended and Restated Declaration, the Floor Areas shall be maintained consistent with the following rules and regulations:

- (a) All Floor Area, including entrances and returns, doors, fixtures, windows, and plate glass shall be maintained by the Owner occupying such Floor Area in a safe, neat, and clean condition;
- (b) All trash, refuse, and waste materials shall be regularly moved from the premises of each Store within the Shopping Center, and until removal shall be stored (i) in adequate containers, which containers shall be covered with lids and shall be located in areas designated by Declarant so as not to be visible to the general public shopping in the Shopping Center, and (ii) so as not to constitute any health or fire hazard or nuisance to any Owner;
- (c) Except as otherwise provided in this Amended and Restated Declaration, neither sidewalks nor walkways shall be used to display, store, or replace merchandise, equipment or devices;
- (d) No advertising medium shall be utilized which can be heard or experienced outside the Floor Area of any Store, including without limiting the generality of the foregoing, flashing lights, search lights, loudspeakers, phonographs, radios or television;

(e) No use shall be made of the Shopping Center or any portion thereof which would (i) violate any law, ordinance, or regulation, (ii) constitute a nuisance, (iii) constitute an extra-hazardous use, or (iv) violate, suspend, or void any policy or policies of insurance on the Stores;

(f) The Owners shall use their diligent efforts to require all trucks servicing their respective Stores to load and unload such trucks (i) prior to the hours the Shopping Center is open to business to the general public or (ii) so as not to unreasonably interfere with the operation of the other Stores within the Shopping Center; and

(g) Each Owner and all other Occupants shall use their diligent efforts, promptly upon receiving notice thereof, to notify Declarant of any significant accident, loss, damage, destruction, or any other situation which arises in or about their respective Stores or the Common Area which could potentially result in a claim or other action against Declarant.

18.3 Conduct of Persons. In addition to any other requirement in this Amended and Restated Declaration, the Owners hereby establish the following rules and regulation for the use of roadways, walkways, and other common facilities (provided that such roadways, walkways, and other common facilities are located in or on Shopping Center Property) provided for the use of Permittees:

(a) No Person shall use any utility area, truck court, or other area reserved for use in the conduct of business, except for the specific purpose for which permission to use such area is given;

(b) No Person shall, in or on any part of the Common Area within an Owner's Parcel without such Owner's permission:

(i) Vend, peddle, or solicit orders for sale or distribution of any merchandise, device, service, periodical, book, pamphlet, or other matter whatsoever, except as otherwise provided in this Amended and Restated Declaration;

(ii) Exhibit any sign, placard, banner, notice, or other written material;

(iii) Distribute any circular, booklet, handbill, placard, or other material;

(iv) Solicit membership in any organization, group, or association or contribution for any purpose;

(v) Parade, rally, patrol, demonstrate, or engage in any conduct that might tend to interfere with or impede the use of any Common Area by any Permittee, create a disturbance, attract attention, or harass, annoy, disparage, or be detrimental the interest of any retail establishments within the Shopping Center;

(vi) Throw, discard, or deposit any paper, glass, or any extraneous matter of any kind, except in designated receptacles, or create litter or hazards of any kind;

(vii) Use any sound-making device of any kind or create or produce in any manner noise or sound that is annoying, unpleasant, or distasteful to the Owners or Permittees; or

(viii) Deface, damage, or destroy any sign, light standard or fixture, landscaping material or other improvement within the Shopping Center, or the property of customers, business invitees, or employees situated within the Shopping Center;

The listing of specific items as being prohibited is not intended to be exclusive, but to indicate in general the manner in which the right to use the Common Area solely as a means of access and convenience in shopping at the retail establishments in the Shopping Center.

IN WITNESS WHEREOF, Declarant has caused this Amended and Restated Declaration to be executed the day and date first above written.

“DECLARANT”

LEDGE ROCK CENTER LLC,
a Kansas limited liability company

By: Michel L Schlup Revocable Trust, a Kansas
Revocable trust, its Member

By: Michel L Schlup

Name: Michel L. Schlup

Its: Trustee

STATE OF KANSAS)
) SS.
COUNTY OF JOHNSON)

The foregoing instrument was acknowledged before me this 29 day September 2023 by Michel L. Schlup, the trustee of Michel L Schlup Revocable Trust, a Kansas revocable trust, member of LEDGE ROCK CENTER, LLC, a Kansas limited liability company under the laws of Kansas, on behalf of said company.

[Signature]
Notary Public

My Commission Expires:

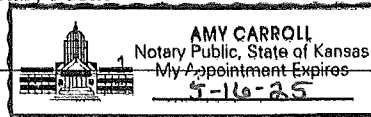

EXHIBIT A-1
LEGAL DESCRIPTION OF THE DECLARANT'S PROPERTY AND PARCELS

LOTS 2, 3, 4, 5 AND TRACT A, WEST LEDGE ROCK CENTER FILING NO. 1, TOWN OF JOHNSTOWN, COUNTY OF WELD, STATE OF COLORADO.

LOTS 1, 2, 3, 4, 5 AND TRACTS A, B, C, WEST LEDGE ROCK CENTER SUBDIVISION FILING NO. 2, COUNTY OF WELD, STATE OF COLORADO.

EXHIBIT A-3
LEGAL DESCRIPTION OF THE METRO DISTRICT'S PROPERTY AND PARCEL

TRACT A, WEST LEDGE ROCK CENTER FILING NO. 1, TOWN OF JOHNSTOWN, COUNTY OF WELD, STATE OF COLORADO.

TRACTS A, B, C, WEST LEDGE ROCK CENTER SUBDIVISION FILING NO. 2, COUNTY OF WELD, STATE OF COLORADO.

EXHIBIT A-4
LEGAL DESCRIPTION OF THE CONTROL PARCEL-

TRACT C, WEST LEDGE ROCK CENTER SUBDIVISION FILING NO. 2, COUNTY OF WELD,
STATE OF COLORADO.

EXHIBIT B-1
SITE PLAN WITH
ACCESS ROADS

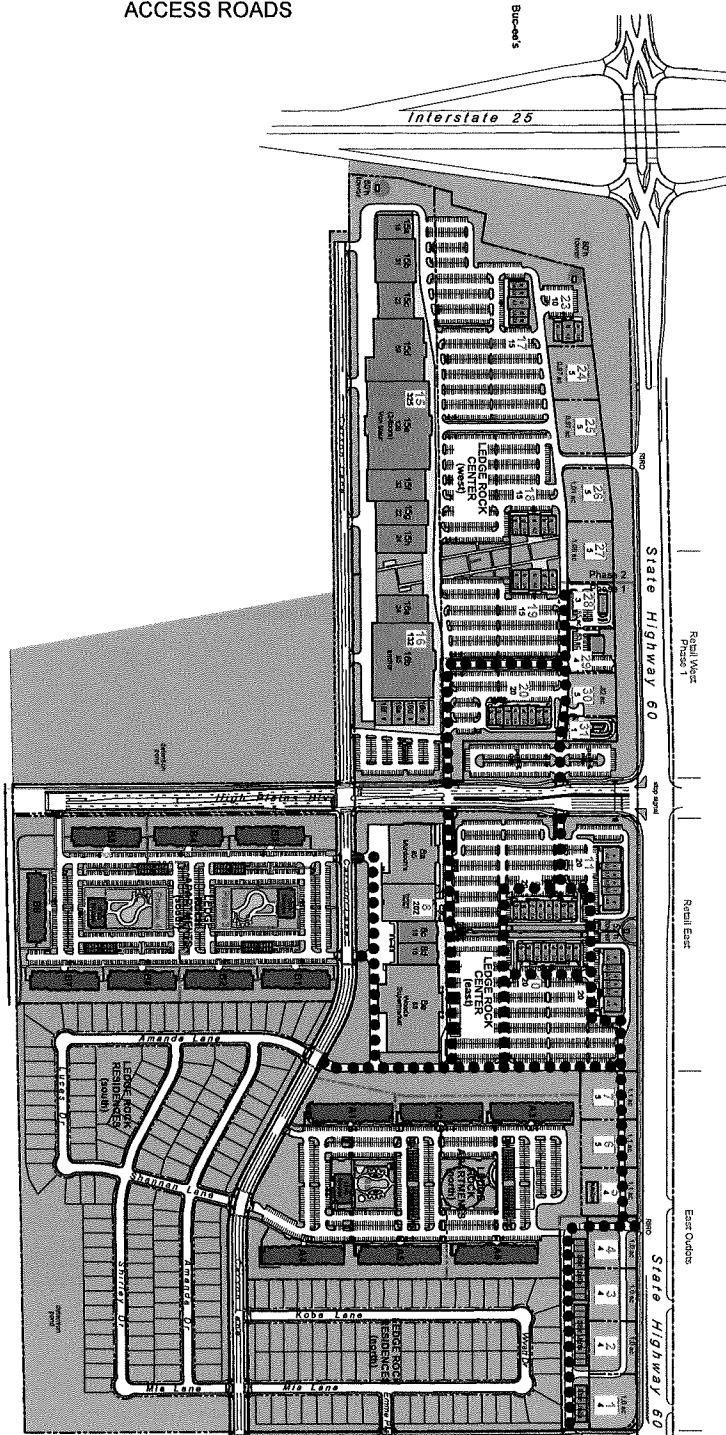

HIGH SCHOOL
(1 mile away)

●●●●● Access Roads
Date: September 22, 2023

- LEGEND:**
- OPEN SHOPS
 - ▨ EXISTING - AVAILABLE
 - ▩ FUTURE - AVAILABLE
 - ▧ FUTURE - PROP LEASE
 - ▦ FUTURE - SIGNED LEASE
 - ▥ EXISTING OPEN RETAIL (by others)
 - ▤ RETAIL - FUTURE (by others)
 - ▣ OFFICE (by others)
 - ▢ APARTMENTS (by others)
- TENANT LIST:**
- BLDG 9a Murdock's
 - BLDG 8a Woods Supermark
 - BLDG 28 Freddy's
 - BLDG 29 Heartland Dental
 - BLDG 31 Coffee Shop

Ledge Rock Center
SEC of I-25 & State Hwy 60, Johnstown, Colorado

Site Plan
Marketing Plan - August 21, 2023
Carson Development, Inc
DeGasperi & Associates Architecture / Point Consulting

EXHIBIT B-4
PLAT FOR EAST LEDGE ROCK CENTER SUBDIVISION
FILING NO. 2 WITH THE CONTROL PARCEL

